

gogo Kidz™ Travelmate

Safety, Assembly & Operating Instructions



Model #UNI06

Go-Go Babyz Corporation

EXPRESS LIMITED WARRANTY

Go-Go Babyz Corporation (“Go-Go Babyz”) warrants this product to be free from defects in materials and workmanship for a period of one year from the date of purchase. Go-Go Babyz will repair or replace, at its sole option, the defective product within that one-year time period.

If you have a problem with your Go-Go Babyz product or are not satisfied with it, please contact Go-Go Babyz Customer Service at 1.888.686.2552.

This express limited warranty does not cover:

- (1) Pick-up, delivery, or freight charges.
- (2) Corrosion caused by improper storage or failure to reasonably protect the product from salt water and adverse conditions.
- (3) Deterioration due to lack of maintenance and cleaning as specified in the product instructions.

Go-Go Babyz SHALL NOT BE LIABLE FOR ANY INCIDENTAL OR CONSEQUENTIAL DAMAGES ARISING FROM BREACH OF ANY EXPRESS OR IMPLIED WARRANTY ON THIS PRODUCT. ANY IMPLIED WARRANTY, INCLUDING IMPLIED WARRANTIES OF MERCHANTABILITY AND FITNESS FOR A PARTICULAR PURPOSE, IS LIMITED TO THE DURATION OF THE EXPRESS, LIMITED WARRANTY (ONE-YEAR FROM THE DATE OF PURCHASE).

Under no circumstance shall any liability of Go-Go Babyz under this Express Limited Warranty, or otherwise, exceed the price of the defective product or parts.

Note: Some states do not allow the exclusion or limitation on incidental or consequential damages, so the above limitation may not apply to you. Some states do not allow limitations on how long an implied warranty lasts, so the above limitation may not apply to you.

This Express Limited Warranty gives you specific legal rights, and you may have other rights, which vary from state to state.

CONTACT GO-GO BABYZ' CUSTOMER SERVICE FOR INFORMATION AND ALL RETURNS:

Go-Go Babyz Returns
7011 Realm Drive, Suite A5
San Jose, CA 95119
408.360.0653

Safety 4

What's Included 6

 Parts for assembling the gogo Kidz 6

 Parts for attaching the gogo Kidz 6

Handle Assembly 7

General Information for Attaching the gogo Kidz 8

General Instructions for Attaching the gogo Kidz 9

 Instructions for Attaching to Britax® & Fisher Price® 10

 Instructions for Attaching to Recaro® 11

 Instructions for Attaching to the Evenflo Triumph 12

Commercial Airlines, Car Seats and the gogo Kidz Travelmate 13

Care and Maintenance 14

DO NOT USE the gogo Kidz™ Travelmate until you read and understand these instructions. Your child's safety depends on you reading and following these instructions.



WARNING: NEVER LEAVE CHILD UNATTENDED.



WARNING: AVOID SERIOUS INJURY FROM FALLING OR SLIDING OUT. ALWAYS USE CAR SEAT RESTRAINT SYSTEM.

Be sure to follow the manufacturer's instructions on how to properly secure your child in their car seat.



WARNING: DO NOT EXCEED WEIGHT AND SIZE LIMITATIONS OF THE CAR SEAT MANUFACTURER OR 50 LBS. MAXIMUM.

This product is to be used as an add-on to your toddler car seat. The warnings and instructions are in addition to the safety manual provided by your car seat manufacturer.



WARNING: DO NOT LEAVE THE GOGO KIDZ ATTACHED TO A CAR SEAT WHILE DRIVING IN AN AUTOMOBILE. THE GOGO KIDZ HAS NOT BEEN TESTED IN COMBINATION WITH THE CAR SEATS IN ANY CRASH TESTING PROGRAM AND INJURY TO YOUR CHILD COULD OCCUR.



WARNING: TO AVOID INJURY, KEEP CHILD AWAY FROM TELESCOPING HANDLE AND THUMBSCREWS. THIS IS NOT A TOY.



WARNING: ALWAYS ENSURE THUMBSCREWS ARE TIGHT WHENEVER THE GOGO KIDZ IS ATTACHED TO THE CAR SEAT.

Injury to your child could result if the unit were to come off accidentally when traveling with your child.

The thumbscrews may loosen over time or have been loosened without a parent's knowledge. Always check the thumbscrews prior to using the gogo Kidz.



WARNING: DO NOT USE WHILE EXERCISING

Do not use this product while running, jogging, in-line skating or participating in other athletic activities.

 **WARNING: EXCESSIVE WEIGHT, PARCELS, OR ACCESSORY ITEMS PLACED OR HUNG ON THE HANDLE MAY CAUSE THE UNIT TO BECOME UNSTABLE.**

Do not place parcels or accessory items on the handle in excess of 3 pounds.

Do not allow children to play with or hang onto the gogo Kidz.

 **WARNING: DO NOT ALLOW CHILDREN TO CLIMB INTO OR OUT OF THE CAR SEAT WHILE GOGO KIDZ IS SECURED, UNLESS YOU ARE HOLDING THE GOGO KIDZ AND INSTRUCTING THE CHILD.**

 **WARNING: NEVER USE THE GOGO KIDZ ON STAIRWAYS OR ESCALATORS.**

 **WARNING: THE GOGO KIDZ IS DESIGNED TO ROLL.**

Make sure the front of the car seat is on the floor and the entire unit is on a flat surface before letting go of the handle.

Accessories which are not approved by the manufacturer or distributor should not be used.

 **WARNING: PLASTIC MATERIAL WILL WEAKEN OVER TIME IF EXPOSED TO EXCESSIVE HEAT OR LIGHT. USE OF THIS PRODUCT SHOULD BE DISCONTINUED 5 YEARS FROM THE DATE OF MANUFACTURER, AS SHOWN ON THE PRODUCT.**

What's Included

Please refer to this page during any part of the assembly instructions and attaching instructions.

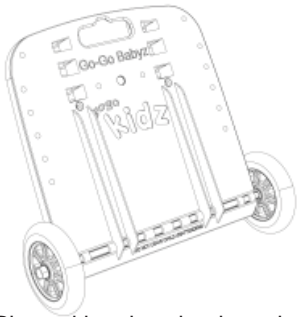

Plate with axle, wheels and push caps

You will use the following parts to assemble the gogo Kidz™ Plate:

- 1 Plate with axle, wheels and push caps already assembled
- 1 Handle
- 2 Handle Screws

You will use the following parts for attaching the gogo Kidz™ Plate to:

Britax® & Fisher-Price®:

- 2 Thumbscrews You will find the thumbscrews located in the retainer bar.
- 1 Retainer Bar

Evenflo® Triumph™:

- 1 Long Strap Please remove the cleats and o-rings from the short strap
- 2 Cleats and O-Rings
- 2 Thumbscrews You will find the thumbscrews located in the retainer bar. They have been inserted into the retainer bar for quality assurance. Please remove from retainer bar prior to any assembly.

Recaro®:

- 2 J-Bolts & Thumb Nuts Located in a separate bag.

Most other car seats:

- 1 Short Strap
- 2 Cleats and O-Rings
- 2 Thumbscrews You will find the thumbscrews located in the retainer bar. They have been inserted into the retainer bar for quality assurance. Please remove from retainer bar prior to any assembly.

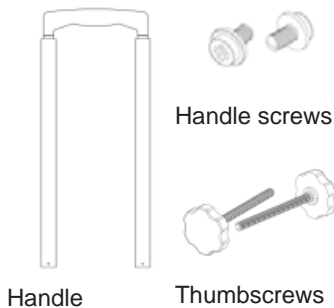

Handle

Thumbscrews

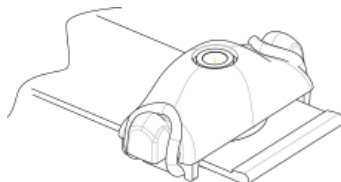

Strap with cleat and o-ring



Retainer bar - for use with Britax®

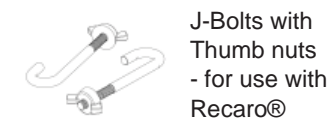

J-Bolts with Thumb nuts - for use with Recaro®

The gogo Kidz™ Travelmate comes pre-assembled except for the handle. Please follow the instructions below to assemble the handle.

A Phillips Head Screwdriver is all that is needed to assemble the handle.

NOTE: It is important that the handle be orientated properly before insertion into the openings of the gogo Kidz plate. There are two ways to make sure the handle is inserted correctly. 1. There is a rivet in each leg of the handle (at the bottom on one side). There is a corresponding slot in the plate that allows the rivet to pass through and still provide a tight fit. 2. Lining up the screw holes in the handle and plate.

1. Insert the handle.

Locate the side of the handle with the pre-drilled holes at the base. Insert the handle into the openings of the gogo Kidz plate, aligning the handle holes to the holes in the plate. Make sure the handle is pushed in all the way to the base of the opening. You may use a rubber mallet if needed to hammer the handle into the plate.

2. Fasten handle to the gogo Kidz plate.

Find the two screw holes on the front of the plate and firmly secure each screw into the existing hole, allowing the screw to go through the metal of the handle. You may use an electric screw driver if desired. Secure them tightly, but do not over tighten. The screws are to prevent the handle from sliding out of the pocket.

NOTE: Drilled holes in the handle may not align exactly with the holes in the plate. This is okay. At first the screw may go in at an angle but it will straighten itself out as you tighten.

IMPORTANT

3. Secure the connection.

Once you have screwed the handle to the plate, pull up on the handle to ensure it is secure.

4. Test the handle.

Open the handle by pushing on the release button located at the top of the handle and test the handle by locking it in the bottom and top positions a few times prior to proceeding onto attaching the gogo Kidz Travelmate to a car seat.

Handle Assembly



Phillips Head Screwdriver



Handle screws

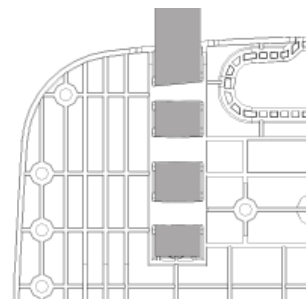

Back of the plate with inserted handle.

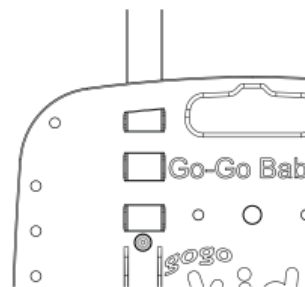

Front of plate with handle inserted and one screw inserted

General Attaching Information

You may use the general instructions below as a quick start guide for attaching the gogo Kidz™ Travelmate to your car seat.



Arrows pointing to car seat ribs

Most car seats have two ribs that go from top to bottom on the back of the car seat with a space between them. The handle area on the back of the gogo Kidz plate goes between the ribs in the space with the smooth, front side of the plate facing out.

Align the two support tabs on the bottom of the gogo Kidz plate at the bottom of the ribs to help support the car seat.

Lay the gogo Kidz plate on the back of the car seat. The wheels should be able to rotate freely.



Arrows pointing to support tabs

Use appropriate attachment (i.e. short or long strap, retainer bar or j-bolts) and fasten to the plate and car seat.

NOTE: Some car seats do not have these two long ribs in the back. For these types of seats, the support tabs on the bottom of the gogo Kidz should be located underneath the base itself.

NOTE: You may be required to move the bar on the back that adjusts shoulder straps to allow the handle to sit properly.

NOTE: The seat recline angle may have to be adjusted to make room for the support tabs or the wheels on some seats.

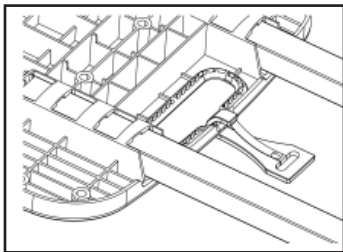

Attaching the tether clip to the gogo Kidz

Attach the tether strap to the handle of the gogo Kidz plate to ensure the gogo Kidz is secure.

RECOMMENDED CAR SEATS

The gogo Kidz™ Travelmate will accommodate most convertible and toddler car seats. Please refer to the list of recommended car seats, located on the back page, to ensure a safe fit. Go-Go Babyz is continually testing new seats with the gogo Kidz and will update our web site frequently whenever we discover a new match or to confirm which seats will not fit with the gogo Kidz. If you do not see your car seat listed on the product box or manual, please check our web site to see if we have had the opportunity to test it with the gogo Kidz.

Instructions below are for attaching to Cosco®, Eddie Bauer®, Evenflo®, Graco® & Safety 1st® car seats. If you are using a Britax®, Fisher-Price®, Evenflo® Triumph™ or a Recaro® car seat, please refer to the appropriate section.

You will use two thumbscrews, the short strap with two cleats attached by two o-rings and the tether strap from the car seat.

1. Place the seat face down on the floor.

2. Align the plate.

Align the two support tabs on the back side of the gogo Kidz plate to the bottom of the car seat and lay the gogo Kidz plate on the back of the car seat. (Please refer to general information if you are having difficulty)

3. Attach the strap.

Begin by securing the end of the strap that has only one grommet to either the left or right side of the gogo Kidz plate. Insert a thumbscrew into the highest hole possible on the plate and thread the thumbscrew into the cleat. The strap should be in between the plate and the cleat. Leave the strap loose because you will tighten it later. Make sure the strap is not twisted. Once one side is attached, thread the strap through the seat belt opening of the car seat.

NOTE: The cleat can be relocated if necessary to fit the needs of your particular car seat. To change the location of the cleat, remove the o-ring that attaches the cleat to the strap. Place the cleat over the proper hole and replace the o-ring.

6. Attach the other side of the strap.

Insert the thumbscrew into the other side of the plate, at the same height as the first side. Begin threading thumbscrew into the cleat. Retighten the first thumbscrew until it is almost flush with the plate. Then retighten the second thumbscrew again.

7. Test the connection.

Once the strap is tightened, lift the car seat and gogo Kidz into the upright position and test the connection by pulling on the handle and moving the gogo Kidz side to side. Retighten the strap.

8. Attach the tether strap.

The tether strap is connected to the car seat and attached onto the handle of the gogo Kidz plate (as shown on the general information page).

NOTE: ALWAYS SECURE YOUR CHILD WITH THE SAFETY HARNESS PROVIDED BY THE CAR SEAT MANUFACTURER.



Make sure tabs align with ribs at the bottom of the car seat. Use opening if available

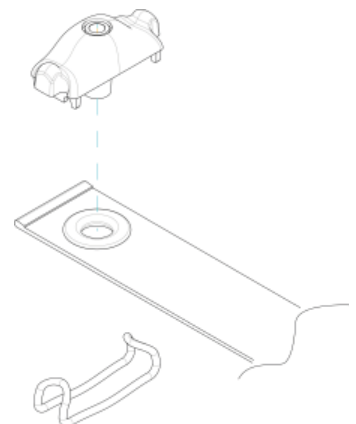

Adjusting the cleat on the strap

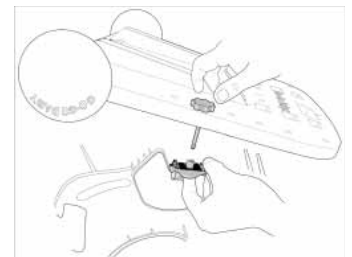

Leave thumbscrew loose until you begin threading opposite side, and then tighten

Attaching to a Britax® or Fisher Price® car seat



Shown above on Britax® Roundabout®



Shown above on Britax® Wizard®

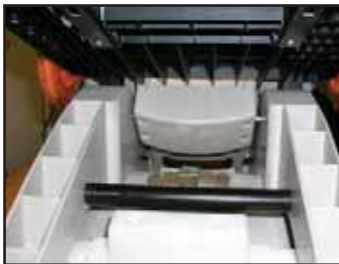

Looking in from the top of the seat (above) bottom (below)



Attaching to the Britax® & Fisher Price® car seats

NOTE: The gogo Kidz does not attach to the Britax® Parkway™

To attach to the Britax® or Fisher-Price® car seats, you will use two thumbscrews, the retainer bar and the tether strap from the car seat.

1. Place the seat face down on the floor.

2. Insert retainer bar.

Place the retainer with the flat side lying against the car seat. If you are using a Wizard® or Boulevard™ car seat, place the retainer bar above the metal bar on the back of the car seat.

3. Align the plate.

Align the support tabs at the bottom of the gogo Kidz plate with the bottom of the car seat and lay the gogo Kidz plate on the back of the car seat.

4. Insert thumbscrews.

Insert the thumbscrews into the two holes located in the center of the plate and tighten. You may need to hold the bar closer to the plate with your other hand while screwing in the thumbscrews. Retighten the first thumbscrew after tightening the second.

5. Test the connection.

Once the retainer bar been attached to the plate and the gogo Kidz is secure, lift the car seat and pull the gogo Kidz into the upright position. Test the connection by pulling on the handle and moving the gogo Kidz side to side. Retighten the thumbscrews as needed.

6. Attach the versa-tether strap.

Pull 10 inches of the “versa-tether” strap from the pouch that is located on the rear of the seat near the top. Pull the strap over the handle and tighten the “versa-tether” by pulling on the end of the tether strap. Place excess strap back into the pouch. Tuck in all remaining latch and tether straps in order not to get tangled when in use.

NOTE: ALWAYS SECURE YOUR CHILD WITH THE SAFETY HARNESS PROVIDED BY THE CAR SEAT MANUFACTURER.

Attaching to the Recaro® car seat

Attaching to the Recaro® car seat

To attach to the Recaro® car seat you will use two j-bolts, two thumb nuts and the tether strap of the car seat.

1. Place the seat on the floor.

2. Attach the j-bolt.

Hook the j-bolt over the L-shaped metal rod on the side of the Recaro® seat and align the gogo Kidz plate so the threaded end of the j-bolt goes through the middle hole on the side of the plate.

3. Attach the Thumb Nut.

4. Repeat steps 2 & 3 for the other side of the seat and plate.

5. Attach the tether strap.

Take the tether strap that is attached to the Recaro® seat and pull it all the way out.

Thread the strap through the shoulder strap opening of the car seat. Refer to seat manufacturers instructions if needed.

Wrap the tether strap around the outside of the gogo Kidz handle and hook the tether clip over the entire strap as shown in pictures.

Tighten the strap and pull on it confirm it is secure.

6. Test the connection.

Once the strap is tightened, test the connection by pulling on the handle and moving the gogo Kidz side to side. Retighten the strap.

NOTE: ALWAYS SECURE YOUR CHILD WITH THE SAFETY HARNESS PROVIDED BY THE CAR SEAT MANUFACTURER.



Make sure the plate of the gogo Kidz is positioned evenly on the back of the car seat. The support tabs on the bottom of the plate will just be touching the bottom of the car seat.



Hook entire width of the tether strap.

Attaching to the Evenflo® Triumph™ car seat



Recline seat



Rest seat onto support tabs



Attach Cleat



Tighten Thumbscrews

Attaching to the Evenflo® Triumph™

To attach to the Evenflo® Triumph car seat you will use the long strap with two cleats and o-rings, two thumbscrews, and the tether strap from the car seat.

1. Recline Seat.

Begin by reclining the Triumph seat all the way in the reclined position. The car seat should be adjusted to lean all the way back otherwise; the child will end up being too vertical.

2. Attach one end of the long strap to a cleat.

3. Align gogo Kidz plate with car seat.

Rest back of car seat onto the support tabs of the gogo Kidz Travelmate plate.

4. Attach the long strap.

Attach the strap/cleat to the plate with one thumbscrew by inserting one thumbscrew into the 2nd or 3rd hole from the bottom of the plate. Do not tighten, yet.

5. Insert the long strap.

Insert the other end of the strap through the seat belt hole located at the back of the car seat.

6. Attach the other end of the strap with the second thumbscrew.

NOTE: Make sure thumbscrews are located in the same position on each side, and then tighten firmly.

7. Test the connection.

Once the retainer bar been attached to the plate and the gogo Kidz is secure, lift the car seat and pull the gogo Kidz into the upright position. Test the connection by pulling on the handle and moving the gogo Kidz side to side. Retighten the thumbscrews as needed.

8. Attach the versa-tether strap.

Pull 10 inches of the “versa-tether” strap from the pouch that is located on the rear of the seat near the top. Pull the strap over the handle and tighten the “versa-tether” by pulling on the end of the tether strap. Place excess strap back into the pouch. Tuck in all remaining latch and tether straps in order not to get tangled when in use.

NOTE: ALWAYS SECURE YOUR CHILD WITH THE SAFETY HARNESS PROVIDED BY THE CAR SEAT MANUFACTURER.

Does the gogo Kidz™ Travelmate fit down the aisle of an airplane? Can I leave it attached on an airplane? Any suggestions about the car seat and the airplanes?

The gogo Kidz is 16 ½ inches wide and fits down the aisle of most commercial airplanes. However, many car seats are wider and they may not fit down the aisle of the coach section. A practical approach is to have your child out of the seat and expect to carry the seat to your assigned seat, once you reach the coach section. The handle on the gogo kidz makes this easier to do than carrying the car seat by itself.

There are dozens of car seat manufacturers with multiple models of car seats. THE GOGO KIDZ™ TRAVELMATE HAS NOT BEEN TESTED IN COMBINATION WITH THE CAR SEATS IN ANY CRASH TESTING PROGRAM. Remove the gogo Kidz and either stow it in the overhead bin or “gate check it.”

Fortunately, the gogo Kidz is very easy to put on and take off. Only one thumbscrew needs to be removed for the strap version and two thumbscrews for the Britax®, Fisher-Price® and Recaro® seats.

Note: We recommend you remove the strap and keep it with you if you check the gogo Kidz Travelmate at the gate.

There have been reports of the aircraft seat belt buckle being stuck behind car seats, creating a removal problem at destination. You may wish to ask the flight attendant for a seat belt extender to eliminate the potential for this problem.

Other airplane information

We are updating our web site, www.gogobabyz.com, to include information and links that offer some very good general information about traveling with children on airplanes, safety issues and other practical suggestions. We recommend you take the time to review this information.

Care & Maintenance

Before connecting the gogo Kidz to your car seat, make sure the unit is assembled correctly and all parts and fasteners are secure.

After assembly pull horizontally on the back of the gogo Kidz to make certain the guides are aligned properly and there is no slippage.

Confirm that thumbscrews are tight.

Periodically check that the handle, axle and wheels are secure.

Replace any damaged parts immediately.

Clean with a damp cloth and wipe dry.

Do not store unit outside exposed to rain or extreme sunlight.

Do not place heavy items on top of unit when storing it.



WARNING: PLASTIC MATERIAL WILL WEAKEN OVER TIME IF EXPOSED TO EXCESSIVE HEAT OR LIGHT. USE OF THIS PRODUCT SHOULD BE DISCONTINUED 5 YEARS FROM THE DATE OF MANUFACTURER, AS SHOWN ON THE PRODUCT.

Thank you!

Thank you for your recent order. We wish you many happy travels with your new gogo Kidz™ Travelmate!

Our goal for Go-Go Babyz is to offer innovative, high quality and safe products to make life easier when you and your baby are “on the go.”

We welcome suggestions and comments. Go-Go Babyz is dedicated to making our current products and features easier to use. Please send ideas for new features, products or general feedback to us at info@gogobabyz.com.

In addition, we have created a photo gallery on our web site for families, like us, using Go-Go Babyz products. Please feel free to email or mail us any photos of you and your children using our products and we would be happy to share them on our Family Photo Gallery page.

Thank you again for your purchase. We appreciate your business.

Sincerely,

The Go-Go Babyz Family

Toll Free: 888.686.2552

www.gogobabyz.com



The gogo Kidz™ Travelmate will accommodate most convertible and toddler car seats. Below is a list of confirmed manufacturer and model names. Go-Go Babyz is continually testing new seats with the gogo Kidz and will update our web site frequently. If you do not see your car seat listed below, please check our web site at www.gogobabyz.com

| Manufacturer | Model Name | Manufacturer | Model Name |
|--------------|--|---------------|---------------------------|
| Britax® | Roundabout® | Fisher-Price® | SafeVoyage™ |
| | Marathon™ | Graco® | Toddler SafeSeat™ |
| | Decathlon™ | | ComfortSport™ Convertible |
| | Boulevard™ | | Treasured CarGo™ Booster |
| | Wizard® | Recaro | Young Sport |
| | Advantage™ | | |
| Cosco® | Alpha Omega® Elite 5-Point High Back Booster | Safety 1st® | 3-Phase Enspira |
| | Summit® High Back Booster | | |
| | Eddie Bauer® | | |
| | Summit Booster | | |
| Evenflo® | Titan™ Deluxe Convertible Car Seat | | |
| | Tribute™ 5 Deluxe Convertible Car Seat | | |
| | Tribute™ VLX | | |
| | Tribute™ V | | |
| | Triumph™ | | |
| | Generations™ Booster Car Seat | | |
| | Harness Booster seat | | |
| | Chase LX Booster | | |

Go-Go Babyz® & gogo Kidz™ Travelmate are trademarks of Go-Go Babyz Corporation. Britax®, Boulevard™, Decathlon™, Marathon™, Roundabout® and Wizard® are trademarks of Britax Child Safety, Inc. Cosco®, Alpha Omega®, Summit®, Safety 1st® and Eddie Bauer® are trademarks of Inc, Dorel Industries, Inc. and/or their affiliates. Evenflo®, Titan™, Tribute™ and Generations™ are trademarks of Evenflo Company, Inc. and/or their affiliates. Fisher-Price® and Safe Voyage™ are trademarks of Mattel, Inc. Graco®, Toddler SafeSeat™, ComfortSport™ and Treasured CarGo® are trademarks of Graco Children's Products. Recaro, Young Sport, Young Export and Young Style are trademarks of Keiper Recaro Group.

The Go-Go Babyz® product illustrated here is not approved by or manufactured under license from Britax Child Safety, Inc, Dorel Industries, Inc., Evenflo Company, Inc., Keiper Recaro Group, Mattel, Inc., Graco Children's Products and/or their affiliates. Go-Go Babyz Corporation is not affiliated with Britax Child Safety, Inc., Dorel Industries, Inc., Evenflo Company, Inc., Mattel, Inc., Graco Children's Products and/or their affiliates.